

B-ALEV 125K-EL-FS

Pressed steel fixed caster, medium duty design, with top plate fitting, and steel foot guard, heavy duty wheel with "Blickle EasyRoll" elastic solid rubber tires, with aluminum wheel center, electrically conductive

EAN 4047526394226

ID 938494

Customs tariff number 87169090



rig: B series

- pressed steel, zinc-plated, blue-passivated, Cr6-free

Wheel: ALEV series

- tire: high-quality elastic solid rubber "Blickle EasyRoll" in smooth rolling quality, hardness 71 Shore A, color black
- wheel center: die-cast aluminium

Other features:

- high chemical resistance to many aggressive substances, except oils
- operating temperature: -5 °F to +175 °F, temporarily up to +210 °F, reduced load capacity over +140 °F
- electrical conductivity (ohmic resistance) $\leq 10^4 \Omega$



Technical data:

Wheel Ø (D)	⌀	125 mm
Wheel width	⊥	40 mm
Load capacity at 4 km/h	⬇	250 kg
Load capacity (static)	⬇	625 kg
Bearing type	⦿	ball bearing
Total height (H)	⊥	150 mm
Plate size	⊞	100 x 85 mm
Bolt hole spacing	⊞	80 x 60 mm
Bolt hole Ø	⌀	9 mm
Temperature resistance min		-20 °C
Temperature resistance max		80 °C
Tread and tire hardness		71 Shore A
Unit weight	⚖	1.3 kg
Non-marking	✗	
Non-staining	✗	
Antistatic	⚡	✗
Electrically conductive	⚡	✓
Corrosion-resistant	✗	
Heat-resistant	🔥	✗
Tread hydrolysis-resistant	✗	
Suitable for autoclaves	✗	
Suitable for machine washing	✗	

Tread and tire hardness

■■■■■ 71 Shore A

Rolling resistance

■■■■■ very good

Wear resistance

■■■■■ good

Operating noise / floor surface preservation

■■■■■ very good

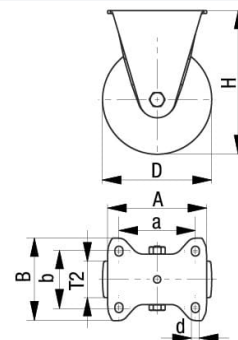

Product references



Corresponding swivel caster L-ALEV 125K-EL-FS



Wheel used ALEV 125/15K-EL