

B-POTHS 200R

Pressed steel fixed caster, medium duty design, with top plate fitting, wheel with soft thermoplastic polyurethane tread, with heavy duty nylon wheel center

EAN 4047526385606

ID 936201

Customs tariff number 87169090



rig: B series

- pressed steel, zinc-plated, blue-passivated, Cr6-free

Wheel: POTHS series

- tread: high-quality thermoplastic polyurethane (TPU), hardness 80 Shore A, color blue, non-marking, non-staining
- wheel center: high-quality nylon 6, impact resistant, color natural white

Other features:

- very high chemical resistance to many aggressive substances
- operating temperature: -15 °F to +160 °F, temporarily up to +195 °F, reduced load capacity over +95 °F

Technical data:

Wheel Ø (D)	☞	200 mm
Wheel width	⏏	50 mm
Load capacity at 4 km/h	⚖	400 kg
Load capacity (static)	⚖	1,000 kg
Bearing type	⦿	roller bearing
Total height (H)	⌀	235 mm
Plate size	📏	140 x 110 mm
Bolt hole spacing	📏	105 x 75–80 mm
Bolt hole Ø	⌀	11 mm
Temperature resistance min		-25 °C
Temperature resistance max		70 °C
Tread and tire hardness		80 Shore A
Unit weight	⚖	1.9 kg
Non-marking	✓	
Non-staining	✓	
Antistatic	✗	
Electrically conductive	✗	
Corrosion-resistant	✗	
Heat-resistant	✗	
Tread hydrolysis-resistant	✗	
Suitable for autoclaves	✗	
Suitable for machine washing	✗	



Tread and tire hardness

■ ■ ■ ■ □ □ 80 Shore A

Rolling resistance

■ ■ ■ ■ □ very good

Wear resistance

■ ■ ■ ■ □ □ good

Operating noise / floor surface preservation

■ ■ ■ ■ □ very good

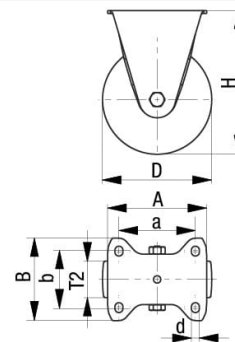

Product references



Corresponding swivel caster L-POTHS 200R



Wheel used POTHS 200/20R