

BES-ALEV 150K-14

Pressed steel fixed caster, heavy duty design, with top plate fitting, heavy duty wheel with "Blickle EasyRoll" elastic solid rubber tires, with aluminum wheel center

EAN 4047526330293

ID 910030

Customs tariff number 87169090

rig: BES series

- particularly robust welded steel construction, zinc-plated, blue-passivated, Cr6-free

Wheel: ALEV series

- tire: high-quality elastic solid rubber "Blickle EasyRoll" in smooth rolling quality, hardness 65 Shore A, color black
- wheel center: die-cast aluminium

Other features:

- high chemical resistance to many aggressive substances, except oils
- operating temperature: -5 °F to +175 °F, temporarily up to +210 °F, reduced load capacity over +140 °F

Technical data:

| | | |
|------------------------------|-----|-------------------------------|
| Wheel Ø (D) | ☞ | 150 mm |
| Wheel width | ⏏ | 50 mm |
| Load capacity at 4 km/h | ⚖ | 300 kg |
| Load capacity (static) | ⚖ | 750 kg |
| Bearing type | ⦿ | ball bearing |
| Total height (H) | ⌀ | 190 mm |
| Plate size | 📏 | 114.3 x 101.6 mm |
| Bolt hole spacing | 📏 | 66,68 x 92,1 / 76,2 x 76,2 mm |
| Bolt hole Ø | 🔩 | 11 mm |
| Temperature resistance min | | -20 °C |
| Temperature resistance max | | 80 °C |
| Tread and tire hardness | | 65 Shore A |
| Unit weight | ⚖ | 2.4 kg |
| Non-marking | ✗ | |
| Non-staining | ✗ | |
| Antistatic | 🔌 ✗ | |
| Electrically conductive | 🔌 ✗ | |
| Corrosion-resistant | ✗ | |
| Heat-resistant | 🔥 ✗ | |
| Tread hydrolysis-resistant | ✗ | |
| Suitable for autoclaves | ✗ | |
| Suitable for machine washing | ✗ | |



Tread and tire hardness

■ ■ ■ □ □ □ 65 Shore A

Rolling resistance

■ ■ ■ ■ □ very good

Wear resistance

■ ■ ■ □ □ good

Operating noise / floor surface preservation

■ ■ ■ ■ □ very good

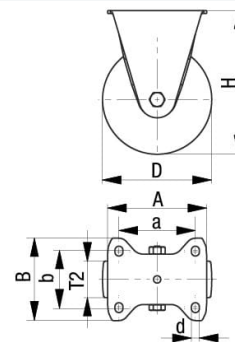

Product references



Corresponding swivel caster LE-ALEV 150K-14



Wheel used ALEV 150/20K