

BX-PATH 125KFD-ELS

Stainless steel fixed caster, with top plate fitting, wheel with thermoplastic polyurethane tread, with nylon wheel center, with synthetic thread guard, large, with additional ball bearing seals, electrically conductive, Non-marking

EAN 4047526209735

ID 853692

Customs tariff number 87169090



rig: BX series

- high-quality chromium-nickel steel (1.4301/AISI 304), stainless steel, vibration-ground finishing
- all parts including axle material are corrosion-resistant

Wheel: PATH series

- tread: high-quality thermoplastic polyurethane (TPU), hardness 94 Shore A, color dark gray, non-marking, non-staining
- wheel center: high-quality nylon 6, impact resistant, color silver gray

Other features:

- large thread guard, with additional, ball bearing seals
- very high chemical resistance to many aggressive substances
- operating temperature: -5 °F to +160 °F, temporarily up to +195 °F, reduced load capacity over +95 °F
- electrical conductivity (ohmic resistance) $\leq 10^4 \Omega$

Technical data:

Wheel Ø (D)	⌀	125 mm
Wheel width	⌀	32 mm
Load capacity at 4 km/h	⬇	160 kg
Load capacity (static)	⬇	400 kg
Bearing type	⊙	ball bearing (C)
Total height (H)	⌀	150 mm
Plate size	⌈ ⌋	100 x 85 mm
Bolt hole spacing	⌈ ⌋	80 x 60 mm
Bolt hole Ø	⌀	9 mm
Temperature resistance min		-20 °C
Temperature resistance max		70 °C
Tread and tire hardness		94 Shore A
Unit weight	⬆	0.7 kg
Non-marking		✓
Non-staining		✓
Antistatic	⌈ ⌋	✗
Electrically conductive	⌈ ⌋	✓
Corrosion-resistant		✗
Heat-resistant	⌈ ⌋	✗
Tread hydrolysis-resistant		✗
Suitable for autoclaves		✗
Suitable for machine washing		✗



Tread and tire hardness

■ ■ ■ ■ ■ 94 Shore A

Rolling resistance

■ ■ ■ ■ ■ very good

Wear resistance

■ ■ ■ ■ ■ very good

Operating noise / floor surface preservation

■ ■ ■ ■ ■ good

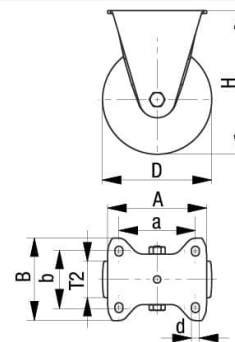

Product references



Corresponding swivel caster LEX-PATH 125KFD-ELS



Wheel used PATH 125/8KFD-ELS