

## B-POEV 161XR

Pressed steel fixed caster, medium duty design, with top plate fitting, heavy duty wheel, with "Blickle EasyRoll" elastic solid rubber tires, with nylon wheel center

EAN 4047526164508  
ID 850388  
Customs tariff number 87169090



### rig: B series

- pressed steel, zinc-plated, blue-passivated, Cr6-free

### Wheel: POEV series

- tire: high-quality elastic solid rubber "Blickle EasyRoll" in smooth rolling quality, hardness 65 Shore A, color black
- wheel center: high-quality nylon 6, impact resistant, color black

### Other features:

- high chemical resistance to many aggressive substances, except oils
- operating temperature: -15 °F to +175 °F, temporarily up to +210 °F, reduced load capacity over +95 °F



### Technical data:

Wheel Ø (D)	160 mm
Wheel width	40 mm
Load capacity at 4 km/h	320 kg
Load capacity (static)	800 kg
Bearing type	roller bearing
Total height (H)	195 mm
Plate size	140 x 110 mm
Bolt hole spacing	105 x 75–80 mm
Bolt hole Ø	11 mm
Temperature resistance min	-25 °C
Temperature resistance max	80 °C
Tread and tire hardness	65 Shore A
Unit weight	1.4 kg
Non-marking	×
Non-staining	×
Antistatic	×
Electrically conductive	×
Corrosion-resistant	×
Heat-resistant	×
Tread hydrolysis-resistant	×
Suitable for autoclaves	×
Suitable for machine washing	×

### Tread and tire hardness

65 Shore A

### Rolling resistance

very good

### Wear resistance

good

### Operating noise / floor surface preservation

very good

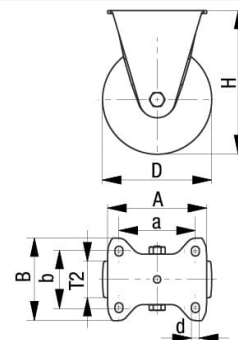

## Product references



**Corresponding swivel caster L-POEV 161XR**



**Wheel used POEV 161/20XR**