

LKR-POEV 100R-FI-SG

Pressed steel swivel caster, heavy duty design, with bolt hole, with brake system 'stop-fix', heavy duty wheel, with "Blickle EasyRoll" elastic solid rubber tires, with nylon wheel center, non-marking, gray

EAN 4047526117214

ID 756818

Customs tariff number 87169090



rig: LKR series

- strong pressed steel, zinc-plated, blue-passivated, Cr6-free
- double ball bearing in the swivel head
- strong central kingpin
- minimum swivel head play and smooth rolling characteristic and increased service life due to the special dynamic Blickle riveting process

Wheel: POEV series

- tire: high-quality elastic solid rubber "Blickle EasyRoll" in smooth rolling quality, hardness 65 Shore A, color gray, non-marking
- wheel center: high-quality nylon 6, impact resistant, color black

Other features:

- high chemical resistance to many aggressive substances, except oils
- operating temperature: -15 °F to +175 °F, temporarily up to +210 °F, reduced load capacity over +95 °F

Technical data:

Wheel Ø (D)	⌀	100 mm
Wheel width	⊥	32 mm
Load capacity at 4 km/h	⬇	200 kg
Load capacity (static)	⬇	500 kg
Bearing type	⊙	roller bearing
Total height (H)	⊘	130 mm
Plate Ø	⊘	88 mm
Bolt hole	⊘	13 mm
Offset (F)	⊘	49 mm
Temperature resistance min		-25 °C
Temperature resistance max		80 °C
Tread and tire hardness		65 Shore A
Unit weight	⚖	1.3 kg
Non-marking		✓
Non-staining		✓
Antistatic	⚡	✗
Electrically conductive	⚡	✗
Corrosion-resistant		✗
Heat-resistant	🔥	✗
Tread hydrolysis-resistant		✗
Suitable for autoclaves		✗
Suitable for machine washing		✗



Tread and tire hardness

■ ■ ■ ■ ■ 65 Shore A

Rolling resistance

■ ■ ■ ■ ■ very good

Wear resistance

■ ■ ■ ■ ■ good

Operating noise / floor surface preservation

■ ■ ■ ■ ■ very good

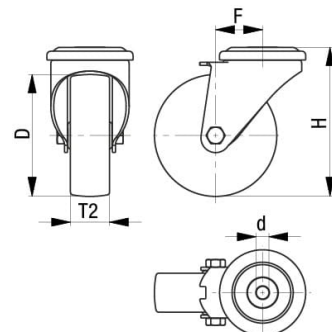
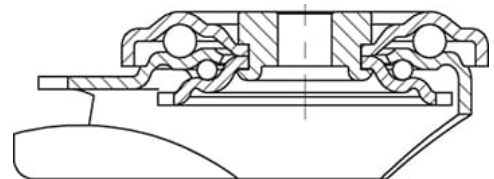

Product references



Corresponding swivel caster LKR-POEV 100R-SG



Wheel used POEV 100/15R-SG