

LKR-ALBS 82K

Pressed steel swivel caster, heavy duty design, with bolt hole, heavy duty wheel with Blickle Bestthane® Soft polyurethane tread, with aluminum wheel center

EAN 4047526076375

ID 754840

Customs tariff number 87169090



rig: LKR series

- strong pressed steel, zinc-plated, blue-passivated, Cr6-free
- double ball bearing in the swivel head
- strong central kingpin
- minimum swivel head play and smooth rolling characteristic and increased service life due to the special dynamic Blickle riveting process

Wheel: ALBS series

- tread: high-quality polyurethane elastomer Blickle Bestthane® Soft, hardness 75 Shore A, color blue, non-marking, non-staining
- wheel center: die-cast aluminium, color silver gray

Other features:

- high chemical resistance to many aggressive substances
- operating temperature: -5 °F to +160 °F, temporarily up to +195 °F, reduced load capacity over +105 °F

Technical data:

Wheel Ø (D)	⌀	80 mm
Wheel width	⊥	40 mm
Load capacity at 4 km/h	⬇	230 kg
Load capacity (static)	⬇	575 kg
Bearing type	⊙	ball bearing
Total height (H)	⊘	110 mm
Plate Ø	⊘	88 mm
Bolt hole	⦶	13 mm
Offset (F)	⦶	40 mm
Temperature resistance min		-20 °C
Temperature resistance max		70 °C
Tread and tire hardness		75 Shore A
Unit weight	⚖	1.1 kg
Non-marking		✓
Non-staining		✓
Antistatic	⚡	✗
Electrically conductive	⚡	✗
Corrosion-resistant		✗
Heat-resistant	🔥	✗
Tread hydrolysis-resistant		✓
Suitable for autoclaves		✗
Suitable for machine washing		✗



Tread and tire hardness

■■■■■□ 75 Shore A

Rolling resistance

■■■■■ excellent

Wear resistance

■■■■■□ very good

Operating noise / floor surface preservation

■■■■■□ very good

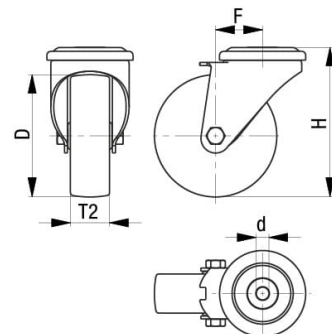
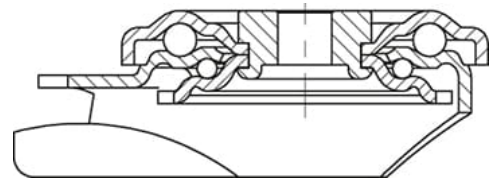

Product references



Corresponding standard locking LKR-ALBS 82K-FI



Wheel used ALBS 82/15K