

## LEZ-VPP 80G-SG

**Pressed steel swivel caster, with stem fitting, wheel with standard solid rubber tire, with synthetic rim, non-marking, gray**

**EAN** 4047526717063

**ID** 717066

**Customs tariff number** 83022000



### **rig:** LEZ series

- pressed steel, zinc-plated, blue-passivated, Cr6-free
- double ball bearing in the swivel head
- minimum swivel head play and smooth rolling characteristic and increased service life due to the special dynamic Blickle riveting process
- steel plug-in stem and central kingpin bolted and secured

### **Wheel:** VPP series

- tire: standard solid rubber, hardness 80 Shore A, color gray, non-marking
- rim: high-quality polypropylene, impact resistant, color black

### **Other features:**

- high chemical resistance to many aggressive substances, except oils
- operating temperature: -20 °C to +60 °C, reduced load capacity over +30 °C

### **Technical data:**

Wheel Ø (D)	⌀	80 mm
Wheel width	⊥	25 mm
Load capacity at 4 km/h	⬆	50 kg
Load capacity (static)	⬆	125 kg
Bearing type	⊙	plain bore
Total height (H)	⊘	102 mm
Stem Ø	⊥	20 mm
Stem length	⊥	50 mm
Offset (F)	⊘	38 mm
Temperature resistance min		-20 °C
Temperature resistance max		60 °C
Tread and tire hardness		80 Shore A
Unit weight	⚖	0.6 kg
Non-marking	✓	
Non-staining	✓	
Antistatic	⚡	×
Electrically conductive	⚡	×
Corrosion-resistant		×
Heat-resistant	🔥	×
Tread hydrolysis-resistant		×
Suitable for autoclaves		×
Suitable for machine washing		×



### **Tread and tire hardness**

■ ■ ■ ■ □ □ 80 Shore A

### **Rolling resistance**

■ ■ □ □ □ □ satisfactory

### **Wear resistance**

■ □ □ □ □ □ sufficient

### **Operating noise / floor surface preservation**

■ ■ ■ ■ □ □ very good

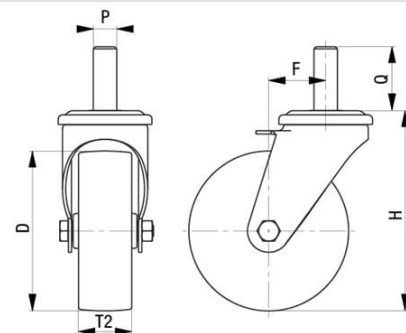
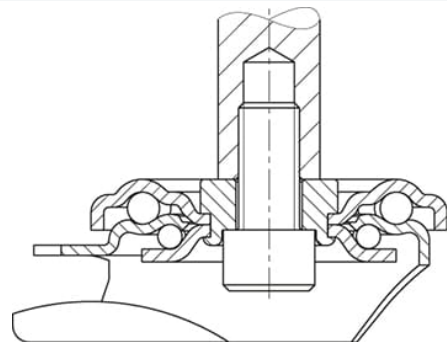

## Product references



**Corresponding standard locking LEZ-VPP 80G-FI-SG**



**Wheel used VPP 80/12G-SG**