

BH-SPO 125G-3-FA

Pressed steel fixed caster, heavy duty design, with top plate fitting, nylon heavy duty wheel, with steel thread guard

EAN 4047526070335

ID 70888

Customs tariff number 87169090



rig: BH series

- pressed steel, zinc-plated, blue-passivated, Cr6-free
- heavy fork and top plate

Wheel: SPO series

- high-quality nylon 6, impact resistant, hardness 70 Shore D, extremely robust heavy-duty version, color natural white

Other features:

- high chemical resistance to many aggressive substances
- operating temperature: -25 °C to +80 °C, reduced load capacity over +35 °C

Technical data:

Wheel Ø (D)	⌀	125 mm
Wheel width	⊥	40 mm
Load capacity at 4 km/h	⚖	700 kg
Load capacity (static)	⚖	1,750 kg
Bearing type	⊙	plain bore
Total height (H)	⊗	165 mm
Plate size	⊞	140 x 110 mm
Bolt hole spacing	⊞	105 x 75–80 mm
Bolt hole Ø	⌀	11 mm
Temperature resistance min		-25 °C
Temperature resistance max		80 °C
Tread and tire hardness		70 Shore D
Unit weight	⚖	1.5 kg
Non-marking		✓
Non-staining		✓
Antistatic	⚡	✗
Electrically conductive	⚡	✗
Corrosion-resistant		✗
Heat-resistant	🔥	✗
Tread hydrolysis-resistant		✗
Suitable for autoclaves		✗
Suitable for machine washing		✗



Tread and tire hardness

70 Shore D

Rolling resistance

excellent

Wear resistance

good

Operating noise / floor surface preservation

satisfactory

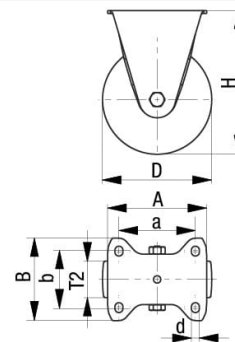

Product references



Corresponding swivel caster LH-SP0 125G-3-FA



Wheel used SP0 125/15G