

## BH-G 127G

**Pressed steel fixed caster, heavy duty design, with top plate fitting, cast iron wheel**

**EAN** 4047526605094

**ID** 605097

**Customs tariff number** 87169090



**rig:** BH series

- pressed steel, zinc-plated, blue-passivated, Cr6-free
- heavy fork and top plate

**Wheel:** G series

- rugged gray cast iron, hardness 180–220 HB, grease nipple, lacquered, color silver

**Other features:**

- chemical resistance to many aggressive substances
- consider the surface pressure on sensitive floors due to high point loads
- provide adequate lubrication on a regular basis for plain bore version
- to be lubricated according to the application temperature

### Technical data:

Wheel Ø (D)	🌀	125 mm
Wheel width	⏏	50 mm
Load capacity at 4 km/h	📦	750 kg
Load capacity (static)	📦	1,875 kg
Bearing type	🌀	plain bore
Total height (H)	📏	170 mm
Plate size	📏	140 x 110 mm
Bolt hole spacing	📏	105 x 75–80 mm
Bolt hole Ø	📏	11 mm
Temperature resistance min		-25 °C
Temperature resistance max		120 °C
Tread and tire hardness		180–220 HB
Unit weight	📦	3.4 kg
Non-marking		✗
Non-staining		✓
Antistatic	🌀	✗
Electrically conductive	🌀	✓
Corrosion-resistant		✗
Heat-resistant	📏	✗
Tread hydrolysis-resistant		✗
Suitable for autoclaves		✗
Suitable for machine washing		✗



### Tread and tire hardness

■ ■ ■ ■ ■ 180–220 HB

### Rolling resistance

■ ■ ■ ■ ■ excellent

### Wear resistance

■ ■ ■ ■ ■ excellent

### Operating noise / floor surface preservation

■ □ □ □ □ sufficient

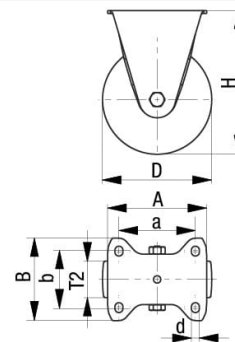

## Product references



**Corresponding swivel caster LK-G 127G**



**Wheel used G 127/20G**