

BS-SPO 150K-FA

Heavy duty welded steel fixed caster, nylon heavy duty wheel, with steel thread guard

EAN 4047526546915

ID 546911

Customs tariff number 87169090



rig: BS series

- particularly robust welded steel construction
- zinc-plated, yellow-passivated, Cr6-free

Wheel: SPO series

- high-quality nylon 6, impact resistant, hardness 70 Shore D, extremely robust heavy-duty version, color natural white

Other features:

- high chemical resistance to many aggressive substances
- operating temperature: -20 °C to +80 °C, reduced load capacity over +35 °C

Technical data:

Wheel Ø (D)	☉	150 mm
Wheel width	⊥	50 mm
Load capacity at 4 km/h	⚖	800 kg
Load capacity (static)	⚖	2,000 kg
Bearing type	⦿	ball bearing
Total height (H)	⊕	200 mm
Plate size	📏	140 x 110 mm
Bolt hole spacing	🔩	105 x 75–80 mm
Bolt hole Ø	⌀	11 mm
Temperature resistance min		-20 °C
Temperature resistance max		80 °C
Tread and tire hardness		70 Shore D
Unit weight	⚖	3 kg
Non-marking		✓
Non-staining		✓
Antistatic	⚡	✗
Electrically conductive	⚡	✗
Corrosion-resistant		✗
Heat-resistant	🔥	✗
Tread hydrolysis-resistant		✗
Suitable for autoclaves		✗
Suitable for machine washing		✗



Tread and tire hardness

70 Shore D

Rolling resistance

excellent

Wear resistance

good

Operating noise / floor surface preservation

satisfactory

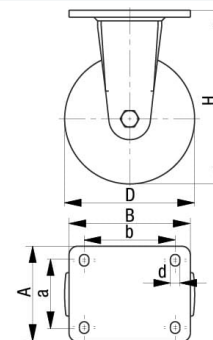

Product references



Corresponding swivel caster LS-SPO 150K-FA



Wheel used SPO 150/20K