

B-PO 150K

Pressed steel fixed caster, medium duty design, with top plate fitting, nylon wheel

EAN 4047526052232

ID 52233

Customs tariff number 87169090



rig: B series

- pressed steel, zinc-plated, blue-passivated, Cr6-free

Wheel: PO series

- high-quality nylon 6, impact resistant, hardness 70 Shore D, color natural white

Other features:

- high chemical resistance to many aggressive substances
- operating temperature: -20 °C to +80 °C, reduced load capacity over +35 °C



Technical data:

Wheel Ø (D)	☉	150 mm
Wheel width	⊥	50 mm
Load capacity at 4 km/h	⬆	400 kg
Load capacity (static)	⬆	1,000 kg
Bearing type	☉	ball bearing
Total height (H)	⌀	190 mm
Plate size	☐	140 x 110 mm
Bolt hole spacing	⌘	105 x 75–80 mm
Bolt hole Ø	⌀	11 mm
Temperature resistance min		-20 °C
Temperature resistance max		80 °C
Tread and tire hardness		70 Shore D
Unit weight	⚖	1.4 kg
Non-marking		✓
Non-staining		✓
Antistatic	⚡	✗
Electrically conductive	⚡	✗
Corrosion-resistant		✗
Heat-resistant	🔥	✗
Tread hydrolysis-resistant		✗
Suitable for autoclaves		✗
Suitable for machine washing		✗

Tread and tire hardness

■ ■ ■ ■ ■ 70 Shore D

Rolling resistance

■ ■ ■ ■ ■ excellent

Wear resistance

■ ■ ■ ■ □ good

Operating noise / floor surface preservation

■ ■ □ □ □ satisfactory

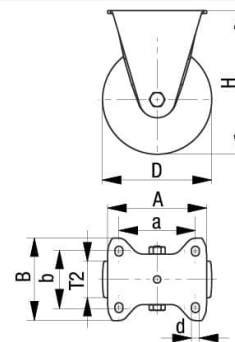

Product references



Corresponding swivel caster L-PO 150K



Wheel used PO 150/20K