

LMDA-TPA 75G

Light duty twin wheel swivel caster, wheel with thermoplastic rubber tread, with polypropylene wheel center

EAN 4047526343538
ID 343533
Customs tariff number 83022000



rig: LMDA series

- pressed steel, zinc-plated, blue-passivated, Cr6-free
- double ball bearing in the swivel head
- pressed swivel head

Wheel: TPA series

- tread: high-quality thermoplastic rubber-elastomer (TPE), hardness 85 Shore A, color gray, non-marking, oil containing
- wheel center: high-quality polypropylene, impact resistant, color silver gray

Other features:

- very high chemical resistance to many aggressive substances
- operating temperature: -20 °C to +60 °C, reduced load capacity over +30 °C
- tread contains oil, may stain sensitive surfaces. alternatives: series VPA, VPP, POES, POEV, PATH

Technical data:

Wheel Ø (D)	☉ 75 mm
Wheel width	⊥ 25 mm
Number of wheels	2
Load capacity at 3 km/h	⚖ 100 kg
Load capacity (static)	⚖ 250 kg
Bearing type	☉ plain bore
Total height (H)	⌀ 98 mm
Plate Ø	⌀ 55 mm
Bolt hole	👁 10,2 mm
Offset (F)	⌀ 34 mm
Temperature resistance min	-20 °C
Temperature resistance max	60 °C
Tread and tire hardness	85 Shore A
Unit weight	⚖ 0.4 kg
Non-marking	✓
Non-staining	✗
Antistatic	ⓧ ✗
Electrically conductive	ⓧ ✗
Corrosion-resistant	✗
Heat-resistant	⚡ ✗
Tread hydrolysis-resistant	✗
Suitable for autoclaves	✗
Suitable for machine washing	✗



Tread and tire hardness

■ ■ ■ ■ □ 85 Shore A

Rolling resistance

■ ■ ■ ■ □ very good

Wear resistance

■ ■ □ □ □ satisfactory

Operating noise / floor surface preservation

■ ■ ■ □ □ good

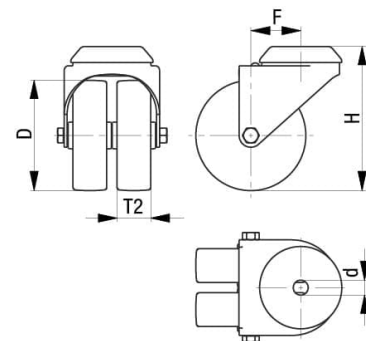
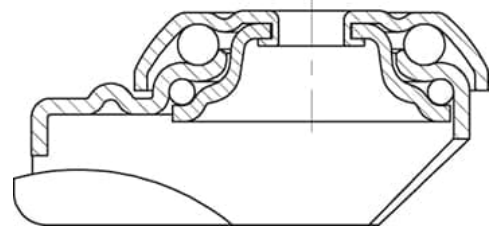

Product references



Corresponding standard locking LMDA-TPA 75G-FI



Wheel used TPA 75/8G