

## BH-POEV 160KA-SG

Pressed steel fixed caster, heavy duty design, with top plate fitting, heavy duty wheel, with "Blickle EasyRoll" elastic solid rubber tires, with nylon wheel center, non-marking, gray, with synthetic thread guard, small

EAN 4047526027049

ID 27045

Customs tariff number 87169090



### rig: BH series

- pressed steel, zinc-plated, blue-passivated, Cr6-free
- heavy fork and top plate

### Wheel: POEV series

- tire: high-quality elastic solid rubber "Blickle EasyRoll" in smooth rolling quality, hardness 65 Shore A, color gray, non-marking
- wheel center: high-quality nylon 6, impact resistant, color black

### Other features:

- with synthetic thread guard, small
- high chemical resistance to many aggressive substances, except oils
- operating temperature: -5 °F to +175 °F, temporarily up to +210 °F, reduced load capacity over +95 °F

### Technical data:

Wheel Ø (D)	☉	160 mm
Wheel width	⊥	50 mm
Load capacity at 4 km/h	⬆	400 kg
Load capacity (static)	⬆	1,000 kg
Bearing type	☉	ball bearing (CC)
Total height (H)	⊕	202 mm
Plate size	⊞	140 x 110 mm
Bolt hole spacing	⊞	105 x 75–80 mm
Bolt hole Ø	⌀	11 mm
Temperature resistance min		-20 °C
Temperature resistance max		80 °C
Tread and tire hardness		65 Shore A
Unit weight	⚖	2 kg
Non-marking	✓	
Non-staining	✓	
Antistatic	⊞	×
Electrically conductive	⊞	×
Corrosion-resistant		×
Heat-resistant	⊞	×
Tread hydrolysis-resistant		×
Suitable for autoclaves		×
Suitable for machine washing		×



### Tread and tire hardness

■ ■ ■ ■ ■ 65 Shore A

### Rolling resistance

■ ■ ■ ■ ■ very good

### Wear resistance

■ ■ ■ ■ ■ good

### Operating noise / floor surface preservation

■ ■ ■ ■ ■ very good

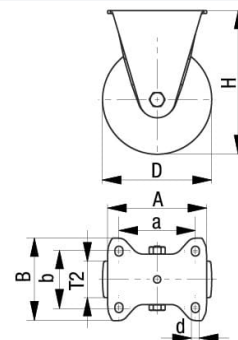

## Product references



**Corresponding swivel caster LK-POEV 160KA-SG**



**Wheel used POEV 160/12KA-SG**